

Installation instructions for: PD162 Xylo Pendant

SAVE THESE INSTRUCTIONS



CAUTION, RISK OF FIRE:

- This product must be installed by a qualified electrician.
- Turn off power at circuit breaker before installing.
- To reduce risk of fire or electrical shock use this fixture indoors only.
- This product is suitable for damp locations.

1 Unthighten pieces following figures 1 to 5

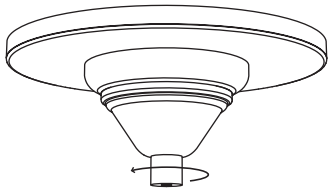

2

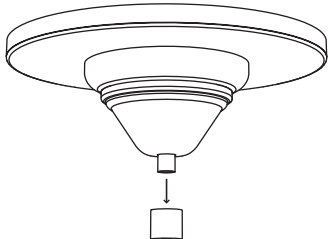

3

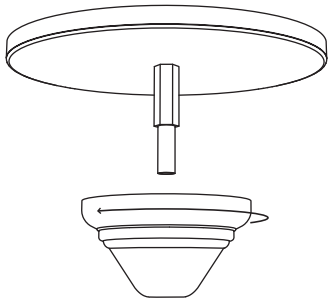

4

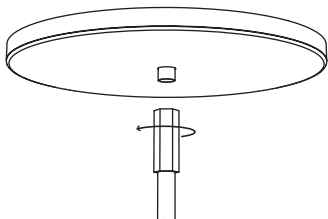

5

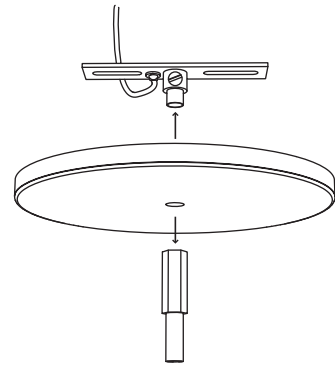

6

Feed the cord through all pieces into the canopy, as shown in below figure.

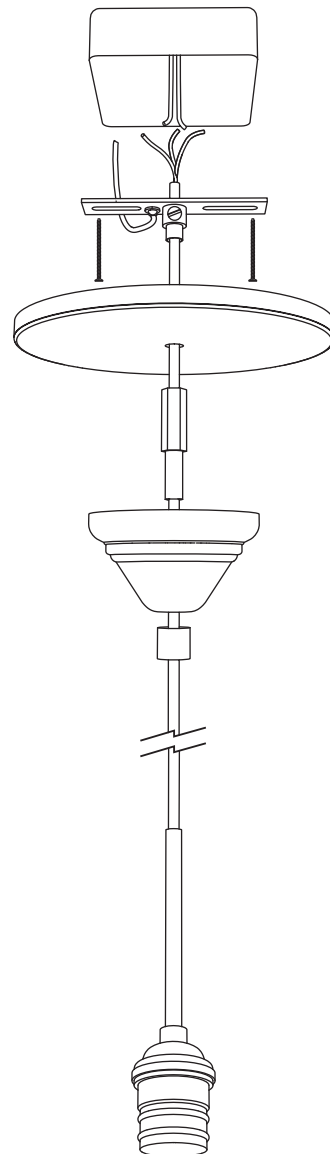

Installation instructions for: PD162 Xylo Pendant

stone
LIGHTING

ADJUST THE FIXTURE HEIGHT

- 7** Adjust the height by moving the cord up or down. use a screwdriver to tighten the setscrew when desired height is achieved.

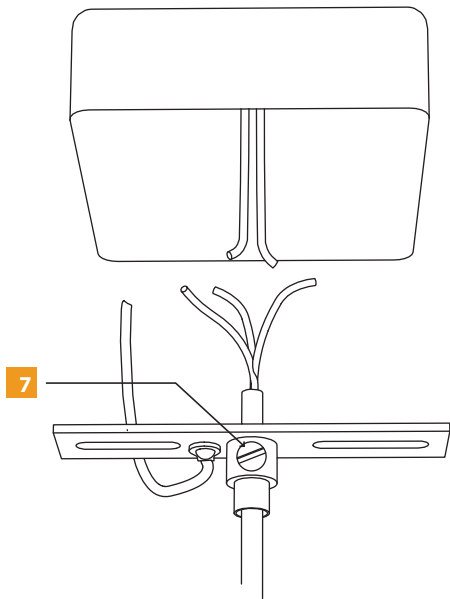

- 8** Connect the black and white wires from the fixture to the corresponding power and neutral wires in electrical box using supplied wire nuts.

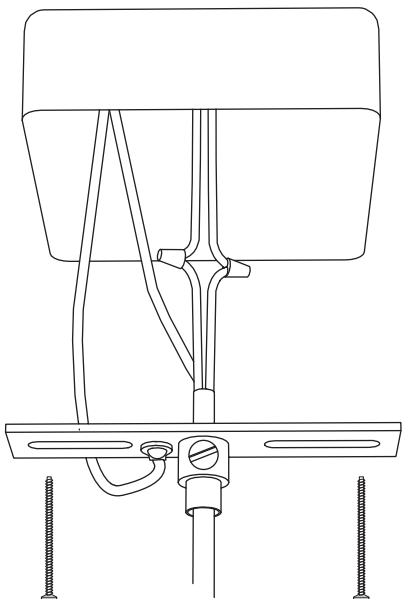

- 9** Install frame with allen set screw onto socket lamp.

- 10** Install lamp.

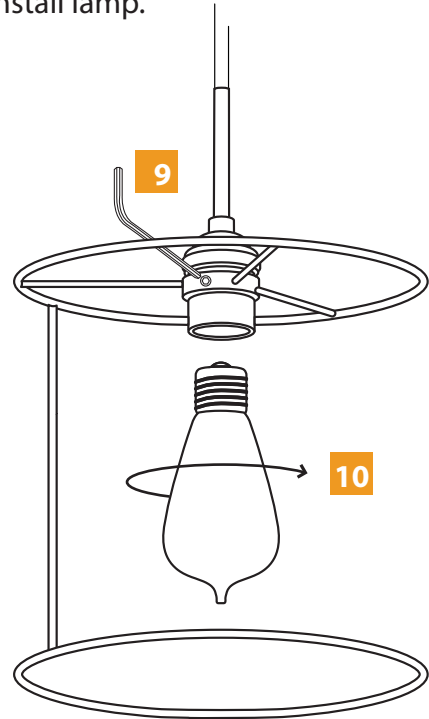

- 11** Install glass pieces in frame. Turn power On.

